

ENFORCER®

MIR-K16S-2101Q

IR Distribution Kit with 6 Ports

Manual



Features:

- 12VDC Operating voltage
- Compatible with 38kHz and 56kHz IR systems
- Six 1/8" (3.5mm) IR emitter output jacks
- 10ft (3m) Cord for IR emitters and receiver
- Status, power, and IR confirmation LEDs
- Status power jack (for switched power supplies to show status)
- 12VDC Power jack (AC adapter included)
- Compact size for easy mounting near audio/video equipment
- Includes mounting screws and tape
- Can accommodate up to 6 dual IR emitters (for a total of 12 controllable devices)
- Kit includes two single IR emitters
- IR Receiver can be extended up to 984ft (300m) with IR Receiver Adapter MIR-AS-01Q (not included)

ENFORCER IR Distribution Kit with 6 Ports

Introduction:

The ENFORCER IR Distribution Kit extends the IR signal from your remote control to remotely operate audio/visual equipment kept in a separate location or in a closed cabinet. The ENFORCER IR Distribution Kit allows for the transmission of IR signals from one IR receiver to up to twelve IR emitters. The wide band IR receiver is capable of receiving IR signals from many types of remotes.

Parts List:

1x IR Connection block	1x IR Receiver	2x Single IR emitters
1x 12VDC Power adapter	2x Mounting screws	(MIR-E-101Q)
1x Mounting tape for receiver	1x Manual	2x Mounting tape for emitters

Specifications:

Operating voltage		12VDC
Zone		1
Emitter ports		6
LEDs		Power (red), Status (green), Receiver (blue)
IR Receiver frequency		30~60 kHz
IR Receiver angle		±45° Off axis
IR Receiver distance	38kHz	40' (12.2m)
	56kHz	25' (7.6m)
IR Emitter frequency		38/56 kHz
IR Emitter angle		±11° Off axis
Connector type	Power/status	2.1mm Coaxial center-pin-positive
	IR Receiver	1/8" (3.5mm) TRS Mini-plug / 4-pin terminal block
	IR Emitter	1/8" (3.5mm) Mono mini-plug
Maximum extended range		984' (300m)*
Operating humidity		10~90%
Operating temperature		32°~158° F (0°~70° C)
Power supply		12VDC/200mA
Dimensions	Connection block	27/16"x115/16"x1" (62x49x25 mm)
	IR Receiver	13/4"x9/16"x1/2" (45x15x12 mm)
	IR Emitter	5/8"x3/8"x1/4" (16x10x6 mm)
Cable length	IR Receiver	10' (3m)
	IR Emitter	10' (3m)
Weight	Connection block	3.9-oz (110g)
	IR Receiver	1.0-oz (28g)
	IR Emitter	0.5-oz (14g)

*With IR Receiver Adapter MIR-AS-01Q (not included). See "IR Receiver Adapter" on pg. 7 for more information.

Overview:

IR Connection Block

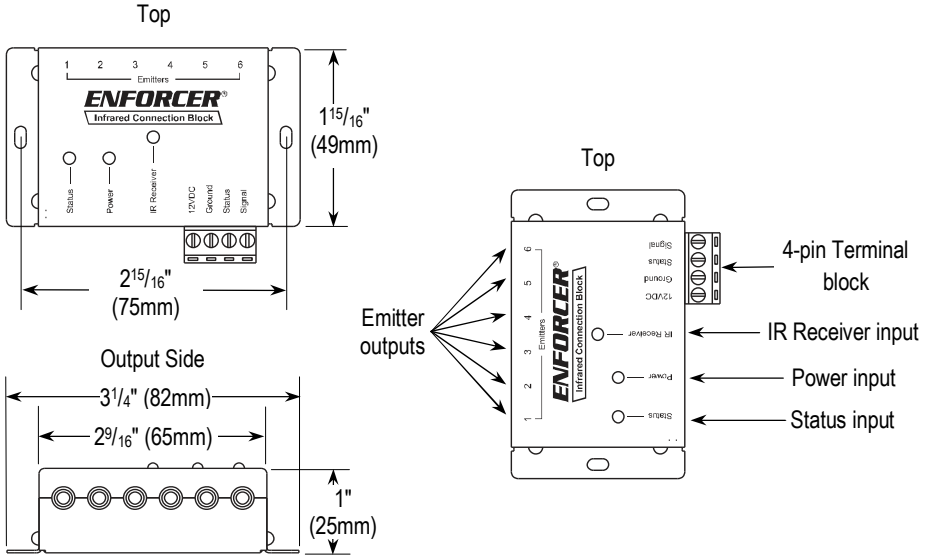

IR Receiver

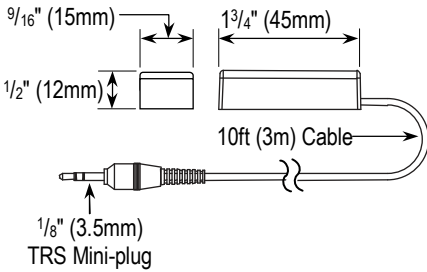

IR Receiver plug

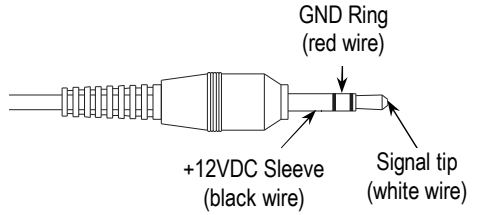

Single IR Emitter (MIR-E-101Q)

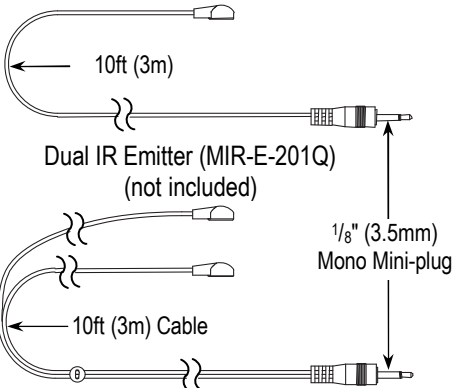

IR Emitter Heads (Detail)

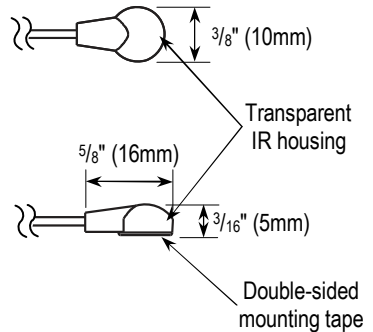

ENFORCER IR Distribution Kit with 6 Ports

Installation:

1. Find a suitable location for the connection block near the AV equipment to be controlled and an AC outlet.
2. Mount the IR connection block using the included mounting screws.
3. Find a suitable location for the IR receiver that is visible by the IR remote (If mounted to a TV, do not block the TV IR receiving window).
4. Connect the IR receiver to the 3.5mm IR receiver input on the connection block.

NOTE: The blue LED will be illuminated when an IR signal is received.

NOTE: The IR receiver includes a 10ft (3m) cord. For remote mounting up to 984ft (300m) away, use the MIR-AS-01Q IR Receiver Adapter (not included) and connect to the 4-pin terminal block IR receiver terminals (see pg. 7, the MIR-AS-01Q "IR Receiver Adapter" section for more information).

5. Mount the IR receiver using the double-sided tape.
6. Mount the IR emitter(s) in one of the following ways:
 - a. Taped directly to the IR receiving window of the device to be controlled.
 - b. On the shelf pointing towards the IR receiving window of the device to be controlled.
 - c. On the cabinet door pointing towards the IR receiving window of the device to be controlled.

NOTE: Additional single IR emitters and dual IR emitters are also available. The connection block can handle up to 6 total single or dual emitters (for controlling up to 12 devices).

7. Connect the IR emitter(s) to the IR emitter port(s) on the connection block.
8. Connect the included 12VDC/200mA power supply into the power input port. The red LED will be illuminated when powered.
9. Optional: Connect an additional 12VDC/200mA power supply into the status power input port. Connect this power supply to a switched outlet or a 12V trigger output. The green LED will illuminate when powered.
10. Test the system to verify that it is functioning properly.

IR Emitter Mounting Options

- a. Attached to Controlled Device IR Receiver Window

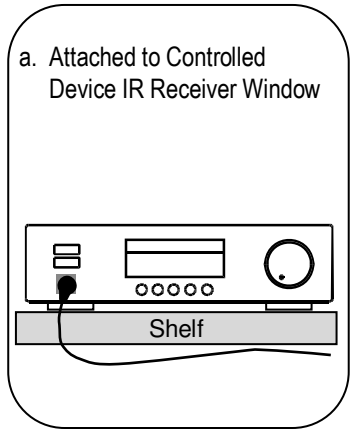

- b. Attached to Shelf

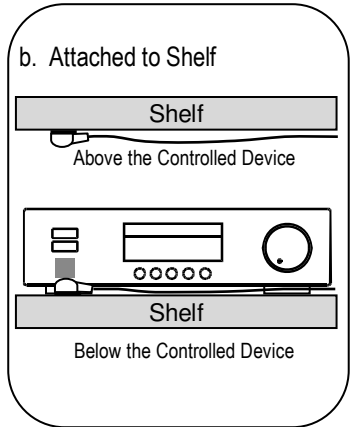

- c. Attached to Door (Side View)

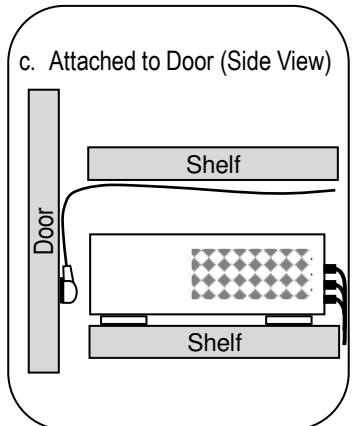

Sample Applications:

Basic Installation (Not to Scale)

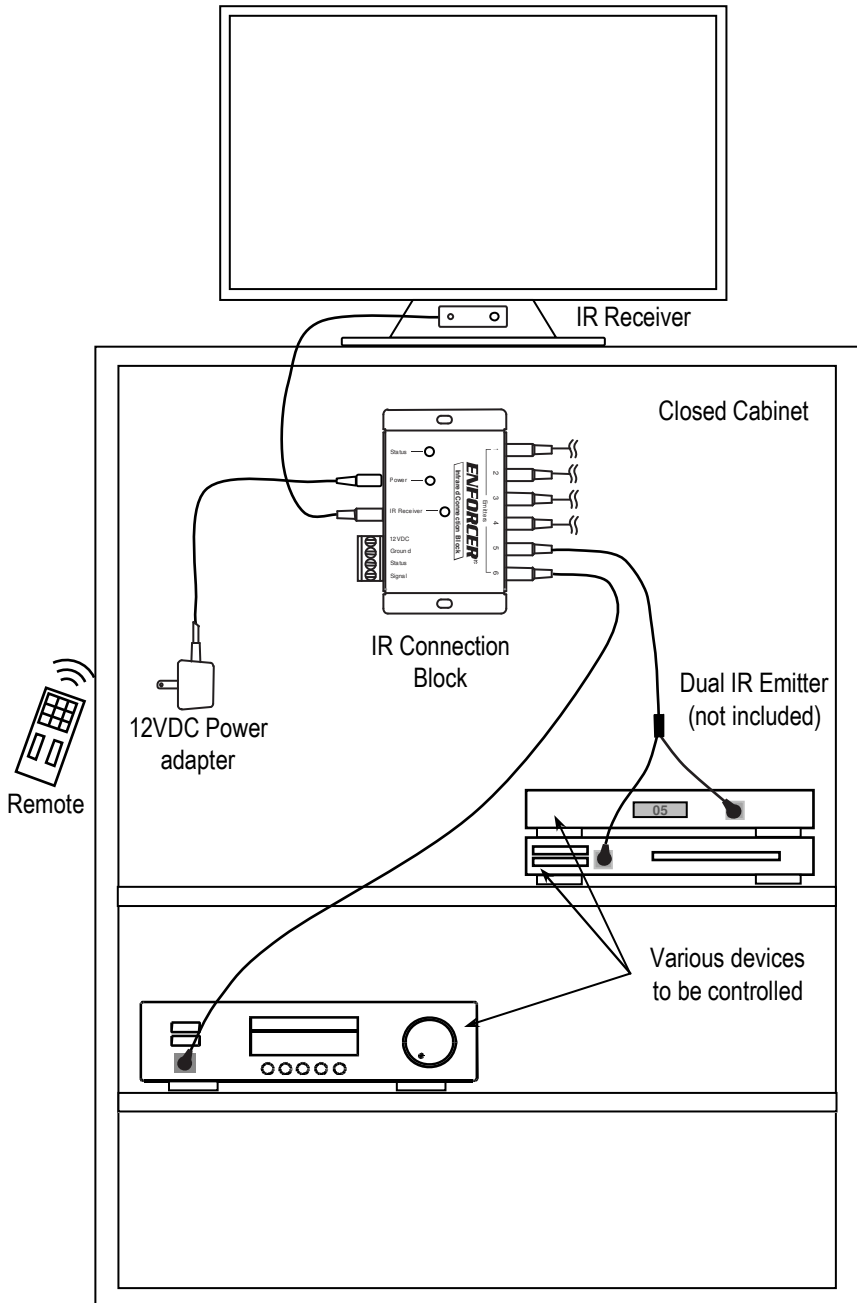

ENFORCER IR Distribution Kit with 6 Ports

Sample Applications (Continued):

Remote Installation (Not to Scale)

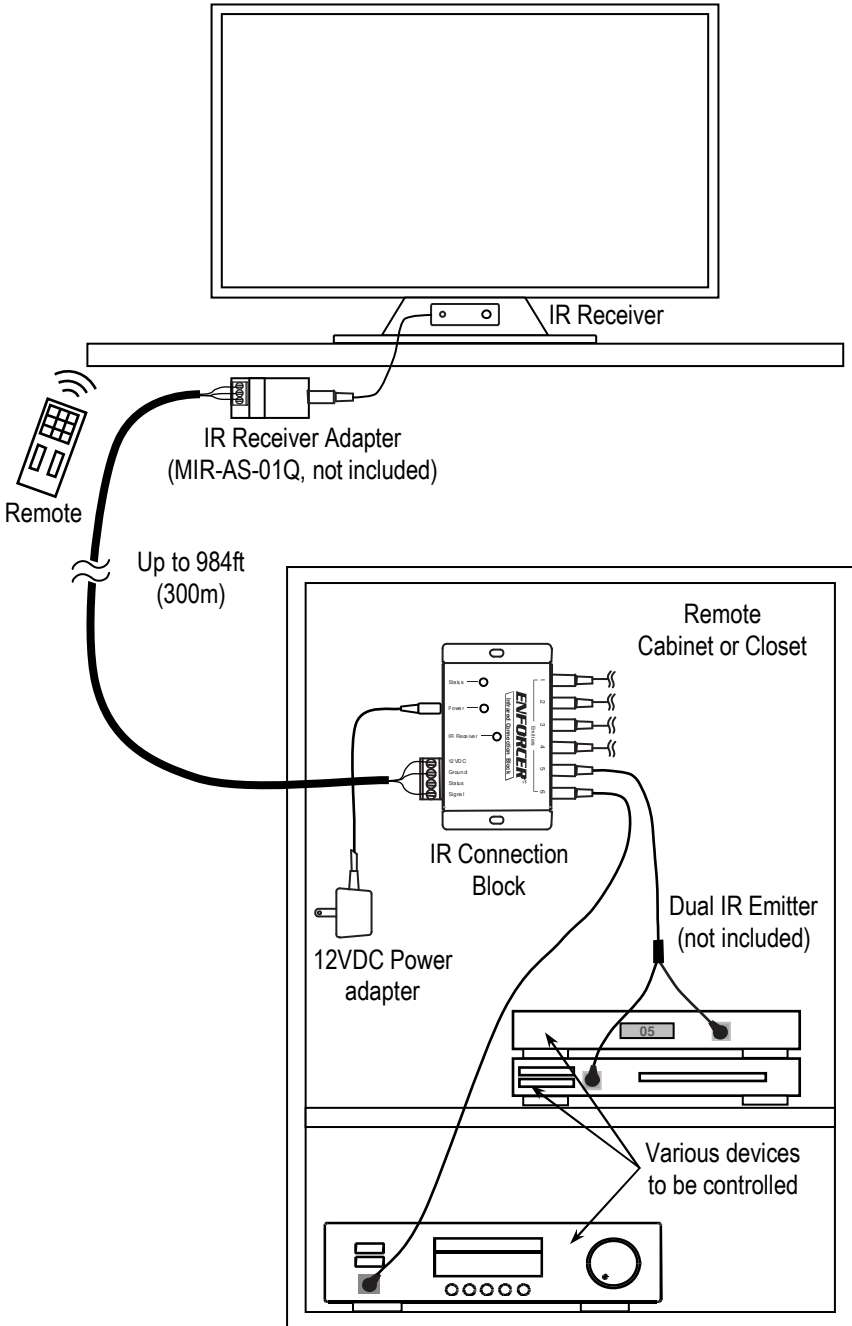

IR Receiver Adapter:

(Additional Accessory)

MIR-AS-01Q



Features:

- Allows extension of an IR receiver without needing to splice the cable
- Quick-connect terminals for easy installation
- 1/8" (3.5mm) TRS Mini-plug connector
- Allows cables up to 20AWG

Overview:

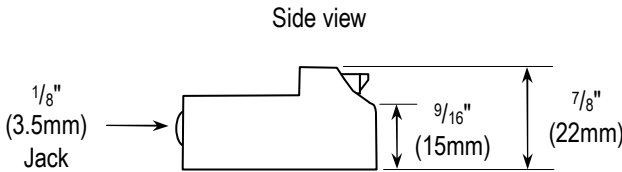
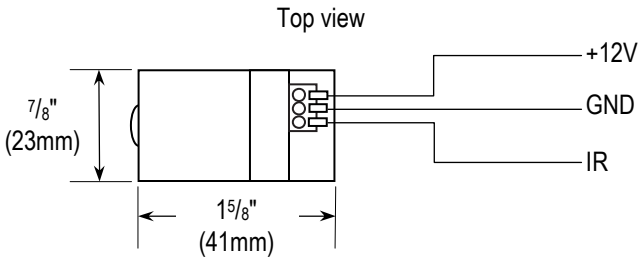

Installation:

(Not to scale)

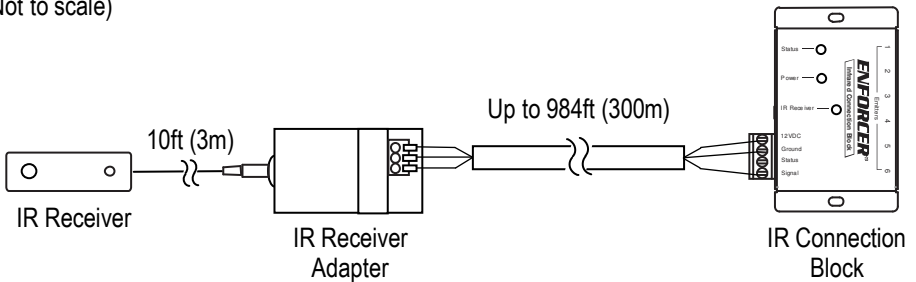

NOTE: The "Status" input on the IR connection block is not used when utilizing the IR Receiver Adapter.

ENFORCER IR Distribution Kit with 6 Ports

Troubleshooting:

The unit will not power on	<ul style="list-style-type: none">• Make sure the 12VDC/200mA power adapter is plugged into the power input, not the status input.
The IR receiver LED lights up but the target device does not react to remote commands	<ul style="list-style-type: none">• Adjust positioning of the IR emitters. It may be necessary to use a flashlight to locate the IR receiving window on the target device.• Make sure the target device and remote are using 30~60 kHz signals. Note that RC-MM commands are not currently supported.
The IR receiver LED does not light up when using the remote	<ul style="list-style-type: none">• Make sure the power supply is firmly connected into the Power input.• Test the remote closer to the IR receiver.• Make sure the IR receiver is correctly connected, either to the IR receiver port or the 4-pin terminal block IR receiver terminals.
The remote needs to be very close to the IR receiver	<ul style="list-style-type: none">• Replace the remote's batteries.

Also Available from SECO-LARM®:

Single IR Emitters



MIR-E-101Q

Dual IR Emitters



MIR-E-201Q

IR Receiver Adapter



MIR-AS-01Q

FCC COMPLIANCE STATEMENT

THIS DEVICE COMPLIES WITH PART 15 OF THE FCC RULES. OPERATION IS SUBJECT TO THE FOLLOWING TWO CONDITIONS: (1) THIS DEVICE MAY NOT CAUSE HARMFUL INTERFERENCE AND (2) THIS DEVICE MUST ACCEPT ANY INTERFERENCE RECEIVED, INCLUDING INTERFERENCE THAT MAY CAUSE UNDESIRABLE OPERATION.

Notice: The changes or modifications not expressly approved by the party responsible for compliance could void the user's authority to operate the equipment.

IMPORTANT NOTE: To comply with the FCC RF exposure compliance requirements, no change to the antenna or the device is permitted. Any change to the antenna or the device could result in the device exceeding the RF exposure requirements and void user's authority to operate the device.

WARRANTY: This SECO-LARM product is warranted against defects in material and workmanship while used in normal service for two (2) years from the date of sale to the original customer. SECO-LARM's obligation is limited to the repair or replacement of any defective part if the unit is returned, transportation prepaid, to SECO-LARM. This Warranty is void if damage is caused by or attributed to acts of God, physical or electrical misuse or abuse, neglect, repair or alteration, improper or abnormal usage, or faulty installation, or if for any other reason SECO-LARM determines that such equipment is not operating properly as a result of causes other than defects in material and workmanship. The sole obligation of SECO-LARM and the purchaser's exclusive remedy, shall be limited to the replacement or repair only, at SECO-LARM's option. In no event shall SECO-LARM be liable for any special, collateral, incidental, or consequential personal or property damage of any kind to the purchaser or anyone else.

NOTICE: The SECO-LARM policy is one of continual development and improvement. For that reason, SECO-LARM reserves the right to change specifications without notice. SECO-LARM is also not responsible for misprints. All trademarks are the property of SECO-LARM U.S.A., Inc. or their respective owners. Copyright © 2018 SECO-LARM U.S.A., Inc. All rights reserved.

SECO-LARM® U.S.A., Inc.

16842 Millikan Avenue, Irvine, CA 92606
Phone: (949) 261-2999 | (800) 662-0800

Website: www.seco-larm.com
Email: sales@seco-larm.com

 PITTM6

ML_MIR-K16S-2101Q_180308.docx