

ENFORCER®

SD-927PWCQ

Wave-to-Open Sensor

Manual



Intertek
5024193
Conforms to
UL294

The ENFORCER Wave-to-Open Sensor uses IR technology to request egress from a protected area or activate a device with the simple wave of a hand. Since no touch is required, this sensor is suitable for use in hospitals, clinics, labs, cleanrooms (to reduce the risk of contamination), schools, factories, or offices.

Features:

- Range up to 2" (5cm)
- White plastic single-gang plate
- 3A relay, triggers minimum 0.5 sec or as long as hand is near the sensor
- Quick connect screw-less terminal block
- LED illuminated sensor area for easy identification
- Selectable LED colors (turns from red to green or green to red) on sensor activation
- Power must be provided by low-voltage power-limited/Class 2 power supply
- Use only low-voltage field wiring and do not exceed 98.5ft (30m)

ENFORCER Wave-to-Open Sensor

Parts List:

1x Wave-to-Open Sensor 2x Mounting screws 1x Decal set 1x Manual

Specifications:

Operating voltage	12VDC	
Current draw (max.)	50mA@12VDC	
Relay type	Form C dry contact, 3A@30VDC	
Response time	10ms	
LEDS	Standby	Red*
	Triggered	Green*
Output time	0.5 sec or as long as hand is near the sensor	
Sensing range	2" (5cm)	
Destructive attack level	Level I	
Line security	Level I	
Endurance level	Level IV	
Standby power	Level I	
Operating temperature	-4°~131° F (-20°~55° C)	
Weight	2.5-oz (70g)	

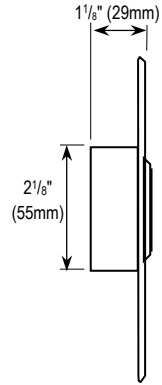

*Default, reversible by jumper

Installation:

1. Run four wires to a single-gang back box. Power must be provided by a low-voltage power-limited/Class 2 power supply and low-voltage field wiring not to exceed 98.5ft (30m).
2. Connect the four wires from the back-box to the quick connect terminals according to Fig. 1.
3. Screw the plate into the back-box, taking care not to crimp the wires.
4. Remove clear protective film from the sensor before use.

INSTALLATION NOTES:

- This product must be electrically wired and grounded in accordance with local codes or, in the absence of local codes, with National Electric Code ANSI/NFPA 70-latest edition or the Canadian Electrical Code CSA C22.1.
- Due to the nature of IR technology, an IR sensor can be triggered by a direct light source such as sunlight, reflected light from a shiny object, or other direct light aimed at the sensor. Consider how to protect the sensor from direct sunlight or other direct, bright light sources.

Adjusting the LED Color:

1. The LED factory default is red (standby) and green (triggered).
2. To reverse the LED color visual indicator to green (standby) and red triggered), remove the jumper located at the right side of the terminal block as shown in Fig. 1.

Care and Cleaning for the Wave-to-Open Sensor:

The SD-927PWCQ is designed for indoor use to match most interiors. The sensor and decals require special care to ensure reliability and a long operating life.

1. Use a soft, clean cloth, preferably a microfiber cloth, to avoid scratching the decals or sensor.
2. Use the mildest cleaner available. Strong cleaning chemicals may damage the decals.
3. When cleaning, spray the cleaning solution onto the cleaning cloth instead of the unit.
4. Be sure to wipe off any excess liquid from the sensor. Wet spots or areas may affect the sensor's performance.

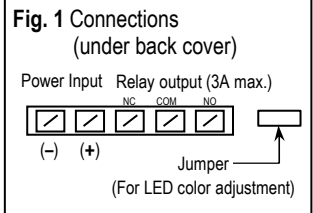

Sample Installations:

1. Installation with Electromagnetic Lock (Fail-Safe)

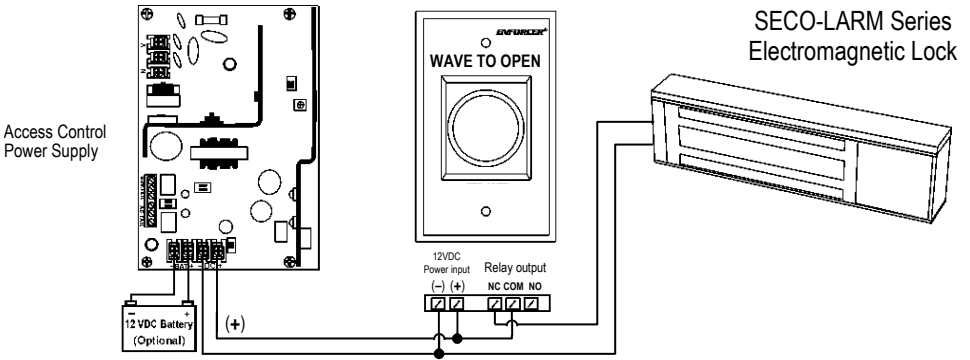

2. Installation with Electric Door Strike (Fail-Secure)

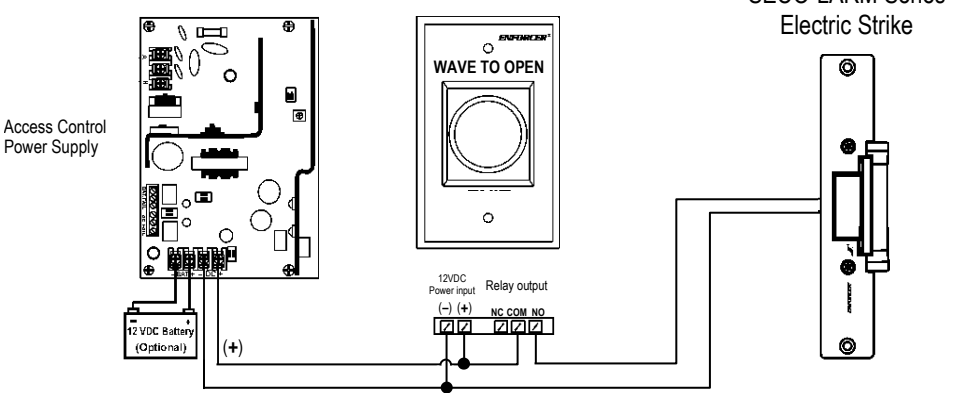

3. Installation with Electromagnetic Lock and Keypad

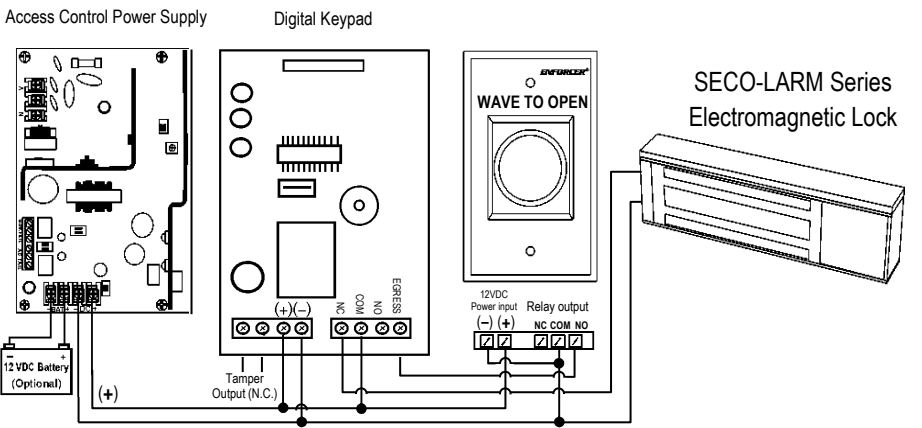

ENFORCER Wave-to-Open Sensor

Troubleshooting:

Sensor triggers unexpectedly	<ul style="list-style-type: none">• Ensure that no strong direct light source or reflected light is reaching the sensor.• Ensure that direct sunlight is not reaching the sensor.
Sensor remains triggered	<ul style="list-style-type: none">• Check that nothing is remaining in range of the sensor including being within a cone of 60° from the centerline.• Check that the power voltage is within the sensor's specifications.
Sensor will not trigger	<ul style="list-style-type: none">• Check that the power voltage is within the sensor's specifications.

Pasting the Decals:

1. Select the appropriate decals in English, French, or Spanish* according to your language requirements.
2. Remove the back sheet of the decal and then set it on the desired location. Use the thin lines on the left and right sides of the text on the decals for alignment, see Fig. 2.
3. After the decal has been placed and set in the desired location, scratch the front of the decal to transfer the text onto the faceplate.

NOTE: The decal needs at least 24 hrs to fully dry & bond to the surface. Do not touch or scratch until the decal is fully dry.

*Decals for the lower part of the plate are provided for Spanish and French only.

Fig. 2 Decal Alignment

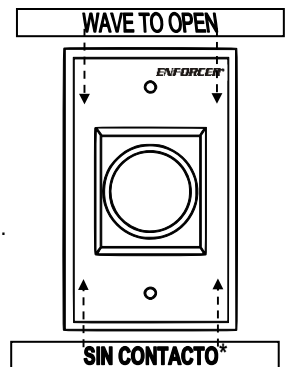

California Proposition 65 Warning: These products may contain chemicals which are known to the State of California to cause cancer and birth defects or other reproductive harm. For more information, go to www.P65Warnings.ca.gov.

IMPORTANT: Users and installers of this product are responsible for ensuring that the installation and configuration of this product complies with all national, state, and local laws and codes related to locking and egress devices. SECO-LARM will not be held responsible for the use of this product in violation of any current laws or codes.

IMPORTANT WARNING: Incorrect mounting which leads to exposure to rain or moisture inside the enclosure could cause a dangerous electric shock, damage the device, and void the warranty.

WARRANTY: This SECO-LARM product is warranted against defects in material and workmanship while used in normal service for one (1) year from the date of sale to the original customer. SECO-LARM's obligation is limited to the repair or replacement of any defective part if the unit is returned, transportation prepaid, to SECO-LARM. This Warranty is void if damage is caused by or attributed to acts of God, physical or electrical misuse or abuse, neglect, repair or alteration, improper or abnormal usage, or faulty installation, or if for any other reason SECO-LARM determines that such equipment is not operating properly as a result of causes other than defects in material and workmanship. The sole obligation of SECO-LARM and the purchaser's exclusive remedy, shall be limited to the replacement or repair only, at SECO-LARM's option. In no event shall SECO-LARM be liable for any special, collateral, incidental, or consequential personal or property damage of any kind to the purchaser or anyone else.

NOTICE: The SECO-LARM policy is one of continual development and improvement. For that reason, SECO-LARM reserves the right to change specifications without notice. SECO-LARM is also not responsible for misprints. All trademarks are the property of SECO-LARM U.S.A., Inc. or their respective owners. Copyright © 2022 SECO-LARM U.S.A., Inc. All rights reserved.

SECO-LARM® U.S.A., Inc.

16842 Millikan Avenue, Irvine, CA 92606
Phone: (949) 261-2999 | (800) 662-0800

Website: www.seco-larm.com
Email: sales@seco-larm.com

 PITSW3

MI_SD-927PWCQ_220801.docx