

## Bluetooth® Access Controller



### SK-B111-PQ Indoor Single-Gang Keypad with Reader

Streamlined, fully app-based setup using integrated Bluetooth® wireless technology. No codes to remember, intuitive app design for easy, visual programming. Provides convenience and security to the user and administrator. All data is secured on the device without the risks inherent with an internet connection.

### Features:

- **No Codes to Remember** – Intuitive, visual app-based programming and management, 200 users, device options, etc.
- **More Than Access** – Can control doors, gates, lighting, machinery, etc.
- **No Internet Exposure** – All data secured locally on device
- **Multiple User Types** – Permanent, scheduled, temporary, # of times
- **Output Modes** – Timed relock, continually unlocked or locked, toggle
- **User Customization** – Individually customizable output mode and time
- **Hold Open** – Hold door open with code or app (customizable)
- **Secure, Integrated Bluetooth** – Passcode protected, AES 128 encryption
- **Authorized User Monitor** – Displays total number of users to guard against unauthorized additions
- **Three Ways to Unlock or Trigger a Device** – Keypad, card, or app
- **Unlimited Devices** – Access/manage unlimited devices with one app
- **Easy Backup/Restore** – For off-device storage / restoration / replication
- **Wrong-Code Lockout and Tamper Alarm Output** – Customizable
- **Multilingual App Interface** – Currently supports English, Portuguese, Spanish, French, German, Russian, Vietnamese, and Chinese (Traditional or Simplified)



### SL Access™ App:



### App-Based Management and Control:

**On-Device Security**  
AES 128 Encryption  
Settings, passcodes kept on device, set by the Administrator

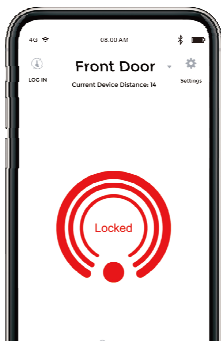

**Administrator Settings**  
Set all device parameters, manage users, view audit trail, backup/restore

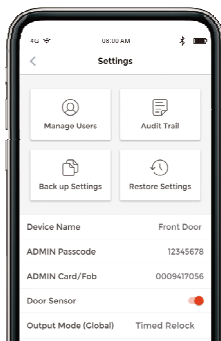

**User Management**  
Add, view, import/export, customize individual settings, scheduling, output settings

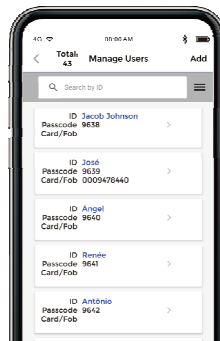

**Audit Trail**  
View most recent 1,000 events, searchable by user and type, and download for archive

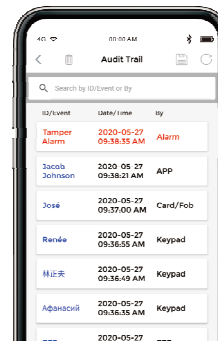

**Unlock with App**  
Users can unlock the door with the app, as well as with the keypad

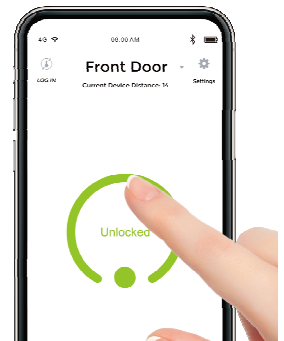

### SECO-LARM® U.S.A., Inc.

16842 Millikan Avenue, Irvine, CA 92606

Phone: (949) 261-2999 | (800) 662-0800 Fax: (949) 261-7326

Website: [www.seco-larm.com](http://www.seco-larm.com) Email: [sales@seco-larm.com](mailto:sales@seco-larm.com)

The Bluetooth® word mark and logos are registered trademarks owned by Bluetooth SIG, Inc. and any use of such marks by SECO-LARM is under license. Other trademarks and trade names are those of their respective owners.



Copyright © 2022 SECO-LARM U.S.A., Inc. All rights reserved.  
All trademarks are the property of SECO-LARM U.S.A., Inc. or their respective owners.  
The SECO-LARM policy is one of continual development. For that reason, SECO-LARM reserves the right to change prices and specifications without notice. SECO-LARM is not responsible for misprints.  
**SECO-LARM® ENFORCER® CRIMEBUSTER® CBA® SLI™**

PL\_SK-B111-PQ\_220701.docx

### Specifications:

Access modes	App / keypad / proximity card
Users	200 users / 1 administrator
Current draw	Standby 50mA@12VDC, 28mA@24VDC
	Active (max.) 58mA@12VDC, 33mA@24VDC
Outputs	Form C 2.0A@30VDC
	Tamper alarm 100mA@30VDC (solid state N.C.)
Output modes	Timed relock (1~1,800s), continually locked, continually unlocked, toggle
Inputs	Egress N.O. Ground
	Door sensor N.C. Ground

Operating voltage	9~25 VDC
Electrical protection	Short circuit, electrostatic discharge, reverse polarity, relay contact protection
Proximity reader	EM 125kHz
Keypad	Backlit
Bluetooth radio	Bluetooth Low Energy (BLE) 4.2
Faceplate material	Stainless steel, ABS plastic
Operating temperature	-4°~122° F (-20°~50° C)
Dimensions	2 <sup>3</sup> / <sub>4</sub> "x4 <sup>1</sup> / <sub>2</sub> "x1 <sup>1</sup> / <sub>4</sub> " (70x114x31 mm)
Weight	3.75-oz (107g)

### Three Ways to Unlock or Trigger a Device:

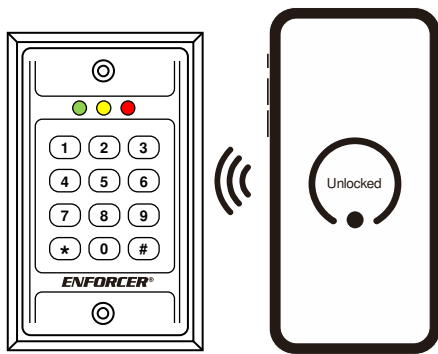

Unlock with the app

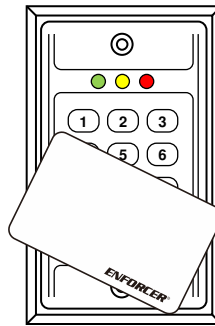

Unlock with a proximity card

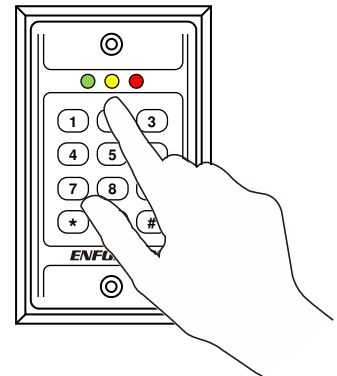

Unlock with the keypad

### Dimensions:

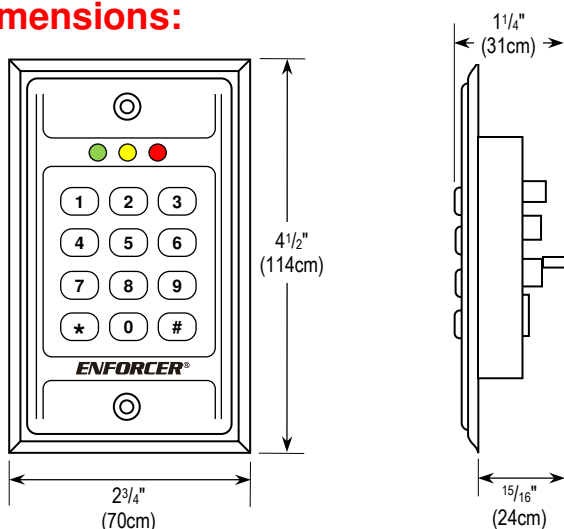

### Download the *SL Access™* App:



iOS 11.0 and higher



Android 5.0 and higher

### SECO-LARM® U.S.A., Inc.

16842 Millikan Avenue, Irvine, CA 92606

Phone: (949) 261-2999 | (800) 662-0800 Fax: (949) 261-7326

Website: [www.seco-larm.com](http://www.seco-larm.com) Email: [sales@seco-larm.com](mailto:sales@seco-larm.com)

The Bluetooth® word mark and logos are registered trademarks owned by Bluetooth SIG, Inc. and any use of such marks by SECO-LARM is under license. Other trademarks and trade names are those of their respective owners.



Copyright © 2022 SECO-LARM U.S.A., Inc. All rights reserved.

All trademarks are the property of SECO-LARM U.S.A., Inc. or their respective owners.

The SECO-LARM policy is one of continual development. For that reason, SECO-LARM reserves the right to change prices and specifications without notice. SECO-LARM is not responsible for misprints.

**SECO-LARM® ENFORCER® CRIMEBUSTER® CBA® SLI™**

PL\_SK-B111-PQ\_220701.docx