

Square Illuminated Pushbutton DPDT Request-to-Exit Plate

SD-7202GF-PEQ

Installation Manual



The ENFORCER Square Illuminated Pushbutton DPDT Request-to-Exit Plate combines an easy to find LED illuminated request-to-exit button with a DPDT output for more installation options. In addition, the pushbutton's message plate can be easily changed from English to French or Spanish during installation.

- DPDT output rated 5A@30VDC/125VAC
- 12~24 VDC Operating voltage, no resistors required
- Large, illuminated pushbutton with caption "PUSH TO EXIT"
- Message language can be easily switched between English, Spanish, and French with 3 included interchangeable plates:



- Includes eight colored 12-inch wire leads with easy-to-attach spade lugs for fast installation
- LED gives over 50,000 hours of illumination
- Includes stainless steel single-gang faceplate
- IP65 Weatherproof

ENFORCER Square Illuminated Pushbutton DPDT Request-to-Exit Plate

Parts List

1x RTE Plate

2x Faceplate screws

2x Replacement message plates*

8x Colored leads

1x Manual

*Spanish and French

Specifications

| | |
|-----------------------|---|
| Operating voltage | 12/24 VDC |
| Current draw | 8mA |
| | 18mA |
| Output | DPDT |
| Type | |
| Rating | 5A@30VDC/125VAC |
| Faceplate type | Single-gang |
| Button type | Large square, LED illuminated (up to 50,000 hours), green |
| Connectors | 8x 12" (25cm) Colored wire leads |
| IP Rating* | IP65 Weatherproof |
| Operating temperature | -40°~167° F (-40°~75° C) |
| Dimensions | 4 1/2"x2 3/4"x2 1/16" (114x70x53 mm) |
| Weight | 3.25-oz (92g) |

*When properly installed

Overview

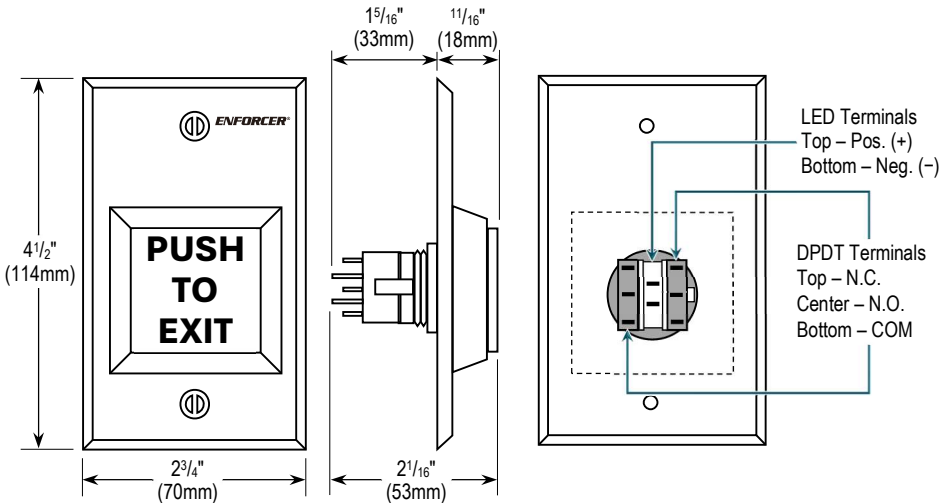

Changing the Message Plate

NOTE: Do this before connecting any wires.

- Carefully twist the switch and bulb assembly clockwise about 20° (see Fig. 1) and then pull it out of the black tube (see Fig. 2).
- Insert the blunt end of a small tool or rod (e.g., a screwdriver or pen, ~3/8" (10mm) diameter) into the black tube (see Fig. 3). It should easily slide all the way in until it contacts the back of the lens/message plate assembly. Push with the tool until the lens/message plate assembly pops off (see Fig. 4), taking care not to lose the spring.
- Take off the transparent green lens and insert the desired message plate.
- Check that message plate orientation is correct.
- Snap the lens assembly back on and replace the switch/bulb assembly in correct orientation (see Fig. 1, ensuring the white tab is on the right side).

Fig. 1

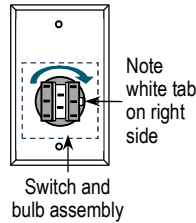

Fig. 2

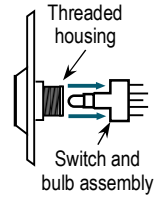

Fig. 3

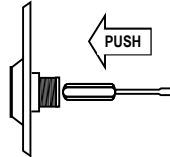
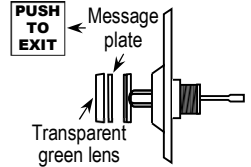

Fig. 4



Wiring

- Run 6 wires through the wall to a single-gang back box:
 - Two wires from a 12VDC or 24VDC power source for the pushbutton light.
 - One wire from either the NO or NC terminal of a device such as an alarm or access control system which can unlock an electrically-controlled lock and one wire from either the NO or NC terminal of a second device.
 - One wire from the COM terminal of each device.

- Connect 6 of the included colored wire spades to the switch lugs (see Fig. 5):

Fig. 5

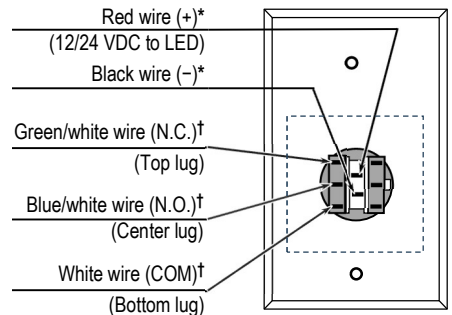

*The polarity of the LED must be observed.

†The opposite side lug terminals are the same.

- To power the LED, connect the red wire (+) to the top lug terminal and the black wire (-) to the bottom lug terminal on the switch's white center area (correct polarity must be observed).
- Connect a green/white wire to one of the N.C. lug terminals (top) on the black/blue switches for each device (for N.C. devices).
- Connect a blue/white wire to one of the N.O. lug terminals (center) on the black/blue switches for each device (for N.O. devices).
- Connect a white wire to one of the COM lug terminals (bottom) on the black/blue switches for each device.

Wiring (Continued)

3. Connect the colored wires to wires from the alarm or access control system and the light's power source (see Fig. 5):
 - a. Red (+) and black (-) wires – to a 12 or 24 VDC source. The correct polarity of the LED must be observed.
 - b. Green/white wires – each to the N.C. terminal of the alarm or access control system (if needed).
 - c. Blue/white wires – each to the N.O. terminal of the alarm or access control system (if needed).
 - d. White wires – each to the COM terminal of the alarm or access control system.
4. Use silicone sealant where the faceplate meets the back box and around the mounting screws for a weatherproof installation. Attach to the back box, taking care not to crimp any wires.

NOTE: Use only low-voltage, power-limited/Class 2 power supply and low-voltage field wiring not to exceed 98.5ft (30m).

IMPORTANT WARNING: For a weather-resistant installation, ensure that the unit is installed in a waterproof back box, and that the faceplate and faceplate screws are properly sealed. Incorrect mounting may lead to exposure to rain or moisture inside which could cause a dangerous electric shock, damage the device, and void the warranty. Users and installers are responsible for ensuring that this product is properly installed and sealed.

IMPORTANT: Users and installers of this product are responsible for ensuring that the installation and configuration of this product complies with all national, state, and local laws and codes. SECO-LARM will not be held responsible for the use of this product in violation of any current laws or codes.

California Proposition 65 Warning: These products may contain chemicals which are known to the State of California to cause cancer and birth defects or other reproductive harm. For more information, go to www.P65Warnings.ca.gov.

WARRANTY: This SECO-LARM product is warranted against defects in material and workmanship while used in normal service for one (1) year from the date of sale to the original customer. SECO-LARM's obligation is limited to the repair or replacement of any defective part if the unit is returned, transportation prepaid, to SECO-LARM. This Warranty is void if damage is caused by or attributed to acts of God, physical or electrical misuse or abuse, neglect, repair or alteration, improper or abnormal usage, or faulty installation, or if for any other reason SECO-LARM determines that such equipment is not operating properly as a result of causes other than defects in material and workmanship. The sole obligation of SECO-LARM and the purchaser's exclusive remedy, shall be limited to the replacement or repair only, at SECO-LARM's option. In no event shall SECO-LARM be liable for any special, collateral, incidental, or consequential personal or property damage of any kind to the purchaser or anyone else.

NOTICE: The SECO-LARM policy is one of continual development and improvement. For that reason, SECO-LARM reserves the right to change specifications without notice. SECO-LARM is also not responsible for misprints. All trademarks are the property of SECO-LARM U.S.A., Inc. or their respective owners. Copyright © 2025 SECO-LARM U.S.A., Inc. All rights reserved.

SECO-LARM® U.S.A., Inc.

16842 Millikan Avenue, Irvine, CA 92606

Phone: (949) 261-2999 | (800) 662-0800

Website: www.seco-larm.com

Email: sales@seco-larm.com

 PITSW1

Order Part# 763-254%

MI_SD-7202GF-PEQ_251103.docx